

Recommended PCB Layout(Top View)

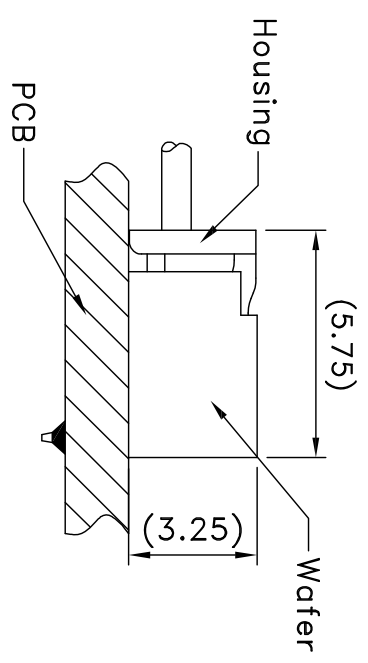

Assemble state

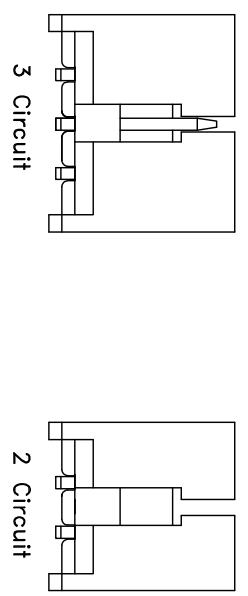
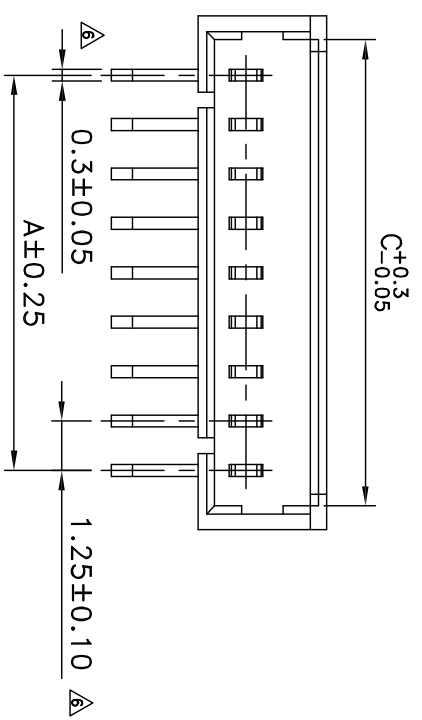
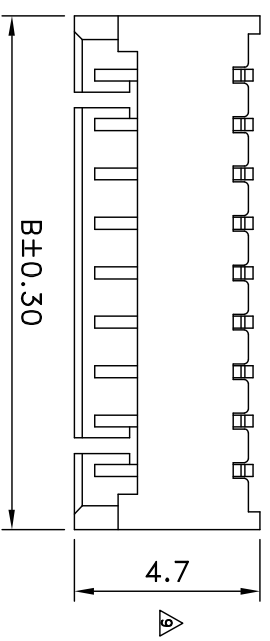
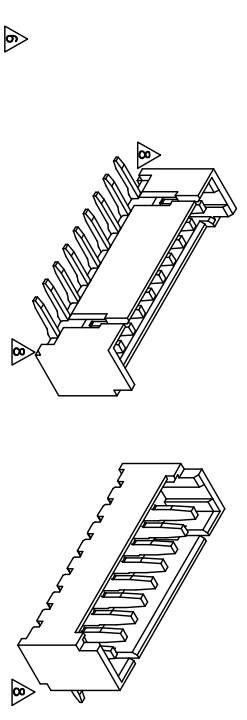
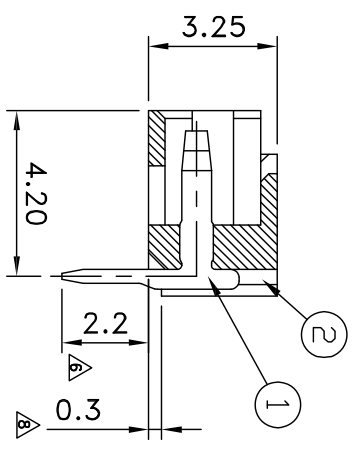

SPECIFICATIONS

- Current Rating : 1A AC/DC
- Withstanding Voltage : 250V AC /minute
- Insulation Resistance : 100M Ω min
- Temperature Range : - 40℃ to + 85℃
- Contact Resistance : 20m Ω max

WAFER

- Part No. : HW12-0xx-R0D-00

Poles : 2-15(DIP Type)

Packing: 1000 pcs/pyc box

- Material : 1.Contact : Brass, Tin Plated  
2. Base : Nylon PA46 UL94V-0  
;Color:Nature
- Finish : Tin Plated

Poles	Dimensions (mm)			Poles	Dimensions (mm)		
	A	B	C		A	B	C
2	1.25	4.25	3.05	9	10.00	13.00	11.80
3	2.50	5.50	4.30	10	11.25	14.25	13.05
4	3.75	6.75	5.55	11	12.50	15.50	14.30
5	5.00	8.00	6.80	12	13.75	16.75	15.55
6	6.25	9.25	8.05	13	15.00	18.00	16.80
7	7.50	10.50	9.30	14	16.25	19.25	18.05
8	8.75	11.75	10.55	15	17.50	20.50	19.30

益富科技 有限公司

TEL:886-3-5511680    FAX:886-3-5511605

PART NO

HW12-0xx-R0D-00

1.25mm Crimp Style Connectors Wafer <DIP>

APPROVED BY	SCALE	UNIT	TOLERANCE	LTR	REVISION RECORD		NAME	DATE	LTR	REVISION RECORD		NAME	DATE
張育瑞		mm	±0.30	△	DG	200509-001		05/09/02	△	改善治盤在時易產生毛邊		李玉國	
CHECKED BY	PROJ	VER NO.	.00 ±0.20	△	RoHS compliant			06/12/30	△	增加尺寸及圖面密			15/04/17
周家慶		Q9	.000 ±0.10	△		200807-006		08/07/03	△				
DRAWN BY	DATE	SIZE	ANGLE ±1°	△		200811-002		08/11/03					
鄭小嬌	2015/4/17	A4	0° ±	△		200910-005	劉怡萱	09/10/23		CUSTOMER			
			.0° ±	△			增加顏色說明	11/04/06		Conforms to The RoHS Instruction			
			SHEET 1/1	△			增加產品規格	12/11/15					