

記號	設 變 內 容	日 期	修 改	核 准
MARK	MODIFICATION	DATE	DRAW	APPROVE
Δ	RELEASED	08/02/2006		
①	RELEASED	08/24/2007		

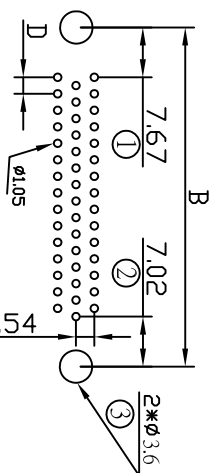

P.B.C BOARD HOLE LAYOUT
P.B.C LAYOUT TOLERANCE:±0.05mm

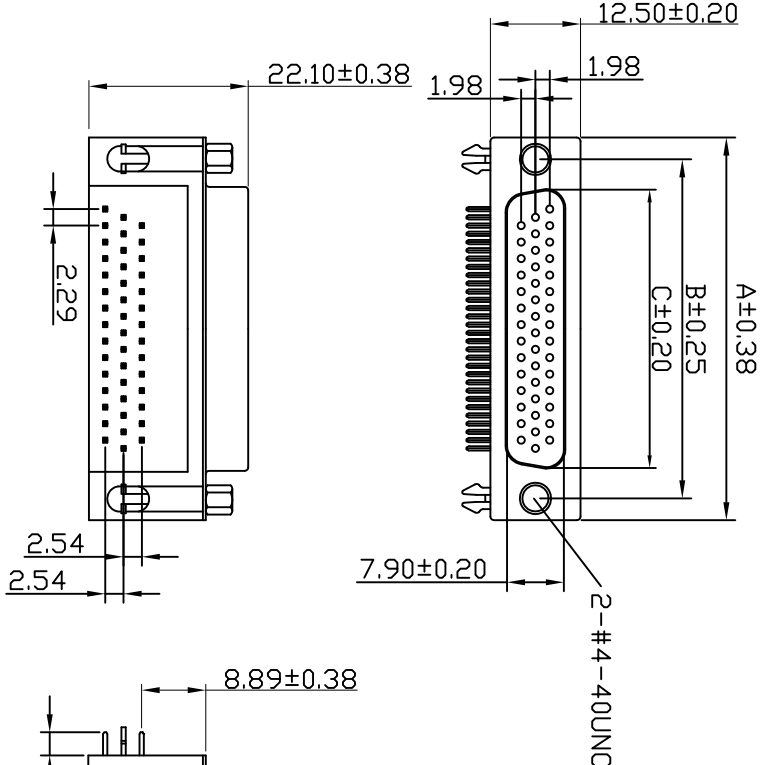

SPECIFICATIONS:
ELECTYICAL:
CONTACT CUREXT RATING: 5 A
DIELECTRIC WITHSTANDING VOLTAGE:AC 500 V.
INSULATION RESISTANCH: 1000MEGDHMS
CONTACT RESISTANCE: 30 MILLOHMS MAX.
OPERATING VOLTAGE:500V.
OPERATING TEMPERATURE:-55 CTD+105 C
MECHANICAL:
CONTACT INSERTION FORCE: 340g MAX.
CONTACT SEPARATION FORCE: 28g MIN.
MATERIAL:
HDSUING:P.B.T+30%GLASS FIBER UL 94V-0 RATED.
INSULATING COLDR :BLUE,BLACK,WHITE,PC99
SPECIFICATION TD BE GIVEN BY CLIENT.
CONTACT:PHOSPHER BRONZE OR TIN PLATED.
FINISH:
CHDICTACT FINISH:GOLD PLATED OVER 50U*NICKELUNDER PLATED.
SOLDER TALL:SN/PB PLATED 100U*OVER 50U*NICKEL UNDER
PLATED
SHELL FINISH: NICKEL<FRONT DHELL>120U* TIN <REAR
SHELL>120U*
*WITH#4-40 SCREW<LOCKASSEMBLED>
*WITH#4-40 SCREW<LOCKUNADDEMBLED>
*RIVET BOARD<IDCK>

ND/PDS	A±0.30	B±0.13	C±0.20	D±0.10
15PIN	30.80	24.99	16.33	2.29
26PIN	39.20	33.32	24.66	2.29
44PIN	53.10	47.04	38.35	2.29
62PIN	69.40	63.50	54.80	2.41

HOW TO ORDER
HDSU-F15-RFD-2A
A: RIVET W/BOARD LOCK/HEX SCREW
SCREW 12.8mm
1: RIVET W/BOARD LOCK/ATTACHED HEX SCREW
SCREW 12.8mm
NO. OF POSITIONS
F:FEMALE M:MALE

HDSU-***-RFD-2A

HDSU-***-RFD-21

益富科技有限公司
TEL:886-3-5511680 FAX:886-3-5511605

UNLESS OTHERWISE SPECIFIED TOLERANCES ARE
±0.30
±0.20
±0.10
±3.0°
±2.0°
±1.0°

繪圖 / 日期	Pictet	單位	MM	名稱 / 料號	D-518 8.89mm HIGH DENSITY R/A FEMALE HDSU-***-RFD-2x
審核 / 日期	Sharon	比例	1:1	材質	Material
Check By/Date	2007/08/24	Scale	1:1	角法	PROJ.
批准 / 日期	Jason	頁次	1/1	版本	REV.
App. By/Date	2007/08/24	SHEET	1/1	角法	PROJ.

